



GR-297/60L/180

SPOT LIGHT MAINTAINED EMERGENCY LUMINAIRE WITH WHITE LEDs

TECHNICAL CHARACTERISTICS

OPERATION VOLTAGE	220-240V AC/50-60Hz
MAXIMUM POWER CONSUMPTION	5.9W / 7.3VA
BATTERY (NI-MH)	4.8V/1.2Ah
BATTERY PROTECTION	Discharge and over charge protection
INDICATIONS - CONTROLS	Battery charging LED, TEST button
CHARGE TIME	24 hours
MINIMUM DURATION	3 hours
LIGHT SOURCE	White LEDs
EMERGENCY ILLUMINATION	330lm / 110lm
DEGREES OF COVER PROTECTION	IP 40
PRODUCED IN ACCORDANCE WITH	EN 60598-1, EN 60598-2-22, EN 55015, EN 61547, EN 61000-3-2, EN 61000-3-3
OPERATION TEMPERATURE RANGE	5 to 40 °C
RELATIVE HUMIDITY	Up to 95%
CONSTRUCTION MATERIAL	Bayblend FR3010, clear polycarbonate
EXTERNAL DIAMENTION	Ø125 x 65 mm
WEIGHT	470gr.
GUARANTEE	3 years (1 year for the battery)

Thank you for purchasing this product of Olympia Electronics. A European manufacturer.

GENERAL

These luminaires are used indoors (ta 40°C) where emergency light is needed.

Each luminaire must be permanently connected to mains power supply.

In normal operation the battery is charging and the illumination source, lights.

In case of a mains power supply failure the luminaire will light the illumination source automatically in emergency mode. When the mains power supply is restored the device turns to normal operation.

INSTALLATION

To install the luminaire follow the installation instructions on page 2.

ATTENTION!!!

1. Operations for installation, maintenance or testing must be done by authorized personnel only.

2. The device must be connected to the mains power supply thru a fuse dependent by the total amount of the line's power load.

3. It is suggested to check every month the indication LED for battery charging, and by pushing the TEST button (use a pointy tool with diameter of 2mm max.) to check the emergency circuit. The illumination LEDs should light as long as the TEST button is

pressed. In the opposite condition contact the installer.

4. It is suggested to check every 6 months the minimum autonomous duration by disconnecting the mains power supply. Count the time that the luminaire lights and in case of less time than the minimum autonomous duration the battery must be replaced. If the measured time is considerably less than the minimum autonomous duration contact the installer. In case of battery or light source replacement, these must be replaced by parts of the same type, by the manufacturer or by a competent person.

5. In case of inactive use for a period greater than 2 months, disconnect the battery by pulling out the battery's connector.

6. **It is not allowed to discard batteries in to common trash bins, they must be discarded only in battery recycling points. Do not incinerate.**

NOTE: LED= Light Emitting Diode

LABELING EXPLANATION:

X: Self contained

1: Maintained (*)

A: Including test device

180: 3 hour duration

(*) Maintained operation: The luminaire lights its illumination source, when it is powered by the mains power supply or not.

Non-Maintained operation: The luminaire lights its illumination source, only in power supply's failure.

INSTALLATION INSTRUCTIONS

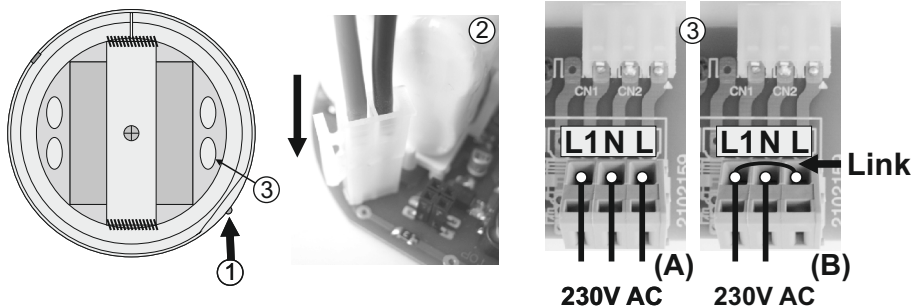

Initial installation

- ① Untighten the screw but do not remove it and pull up the reflector.
- ② Place the battery's connector to the corresponding connector on the P.C.B.
- ③ **Use any round supply cable with an external diameter of 4,5-8m (H05RN-F type 2x1mm² or any other type, at least equal to it's mechanical and electrical properties). WARNING!! The cable must not be deformed in order to preserve the IP rating.** Use a cable grommet type PG9 (Not supplied in the package) and pass the cable. Tighten the cable gland to form the seal. Connect the wires **N** for neutral, **L** for live wire and **L1** for the maintained operation. The L1 wire can be connected to an external switch to control the maintained or non maintained operation of the luminaire **(A)**. For permanent maintained operation **(B)** use two wires to power the luminaire, N for neutral and L for live wire, and link the L and L1 as shown in the picture.
- ④ Refit the reflector (mind the correct orientation), tighten the screw securely and the luminaire is ready for mounting.

NOTE!! After finishing the installation you must power the luminaire at least for 24 hours for battery charging to perform the named autonomy.

To mount the device in a suspended ceiling follow the steps of the "Mounting the lamp" section.

For surface mounting (on wall or on ceiling) follow the steps of the "Surface mounting" section.

Battery replacement.

It can be done only by a competent person and after the mains interruption.

1. Remove the luminaire from the suspended ceiling (figure 3).
2. Follow the step 1 of the installation instructions.
3. Disconnect the connector and remove the old battery.
4. Connect the new battery with the same type (step 2 of the installation instructions) and place it in the position of the old one.
5. Replace the removed parts (step 1 and 4 of the installation instructions) and power the device.

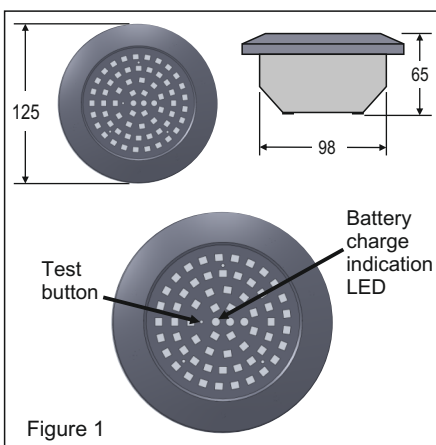

Mounting the lamp in suspended ceiling.

Set up the lamp to the suspended ceiling as it is shown below (*Required opening 110mm*):

Step 1

Bend the springs, to get into the hole of the suspended ceiling, as you can see to the next figure.

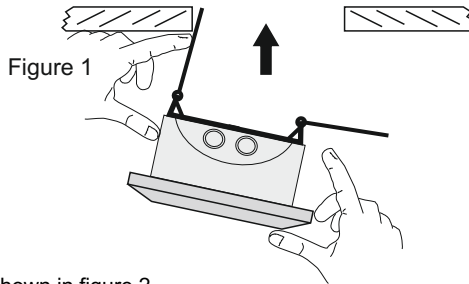

Step 2

Push up the luminaire, as shown in figure 2.

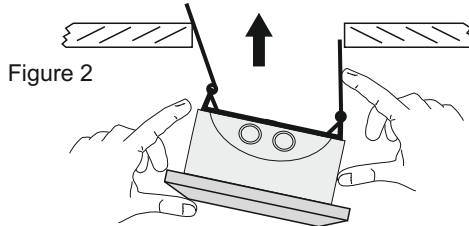

Step 3

Continue to push upwards until the lamp locks.

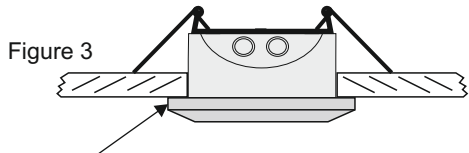

If you want to pull off the device, put a flat blade screwdriver, between the device and the ceiling.

Surface mounting. Install the luminaire according to following steps:

Step 1. Follow the step 1 of the installation instructions.

Step 2. Unfasten the retaining screw 4 and detach the part for suspended ceiling installation.

Step 3. Install the base with the included mounting parts 5.

Step 4. Follow the step 2,3 and 4 of the installation instructions.

