

	GR-392/L/MAR
	220-240V AC/50-60Hz
	5W/ 8VA
(Ni-Cd)	3,6V/3Ah
-	LED charge, lamp fault, fault, (TEST)
	24
	180
	2X16 LED
(230V /)	220/220lm
	IP 40
	EN 60598-1, EN 60598-2-22, 55015, 61547, 61000-3-2, 61000-3-3, IEC 60092-306, IEC 60533
	5 to 40 °C
	Up to 95%
	Bayblend FR3010, polycarbonate
	350 x 134 x 60 mm (CRV 362 x 134 x 90 mm)
	970gr (CRV 1050gr)
	3 (1 μ)

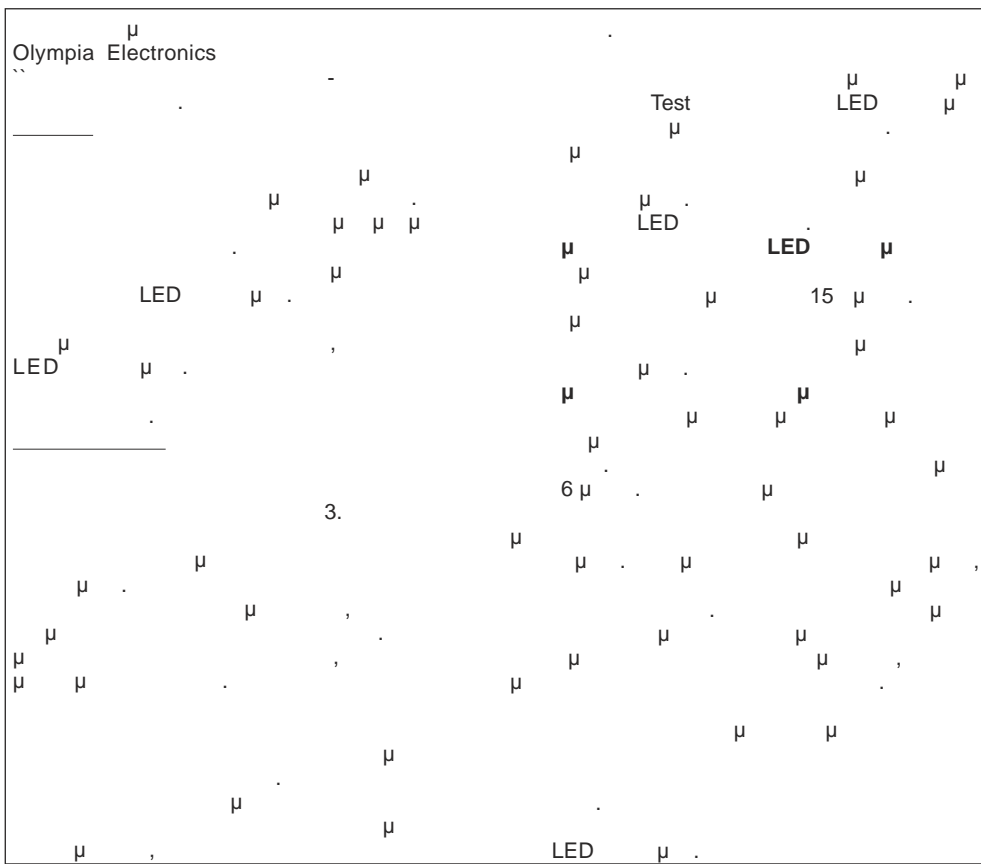

- 1. μ μ μ μ
- 2. μ μ
- 3. μ
- 4. μ μ μ
- 5. μ μ 1 2 μ

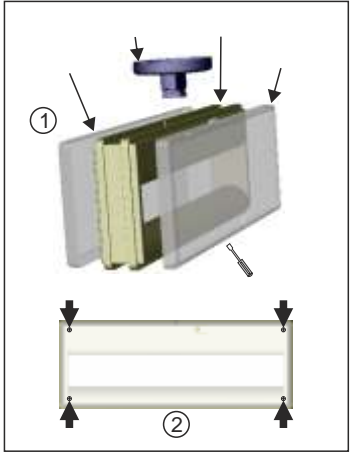

μ : LED= μ

X: μ μ μ

1:

A:

180: 180min ()

(*) _____ : μ , μ

_____ : μ ,